

EVENTS ^{AT} CORINTHIA



DISCOVER THE SPIRIT OF CORINTHIA

WE ARE A FAMILY OF UPSCALE HOTELS ACROSS EUROPE
AND BEYOND. HOSPITALITY IS OUR PASSION AND CARE
IS OUR CRAFT. JUST AS CRAFTSMEN IN OTHER FIELDS
OF LUXURY APPROACH THE CREATION OF THEIR
PRODUCTS, WE TOO WORK TIRELESSLY TO CRAFT
THE ULTIMATE HOTEL EXPERIENCE.

The Craftsmanship of Care



ENTRUST YOUR EVENT TO CORINTHIA

At Corinthia, we fully understand the importance of successfully hosted meetings and events. With a vast offering of bespoke venues, we provide some of the world's most dynamic event professionals, whose passion and dedication to their craft knows no boundaries. With our intuitive expertise and results-driven approach, we present the ultimate framework that breathes life into your vision.

THE LOBBY LOUNGE AT
CORINTHIA HOTEL LONDON



OUR HOTELS

The Corinthia portfolio consists of nine individually-designed, distinctive hotels in some of the most exciting parts of the world.

Diverse in culture, architecture and design, each Corinthia Hotel embodies its own unique personality. We reflect local sensibility whilst staying true to our uncompromisingly high standards.

Leading technology is available throughout each hotel, including free WiFi in all guestrooms, meeting spaces and public areas. Extraordinary restaurants, destination bars, luxurious spas and beautifully-equipped gyms complete our offering.



THE BALLROOM AT
CORINTHIA HOTEL BUDAPEST

OUR PROMISES

COMPLIMENTARY WIFI THROUGHOUT ALL CORINTHIA HOTELS

We provide free WiFi in all meeting rooms, break-out spaces, guestrooms and public areas.

PROMPT RESPONSE TO ENQUIRIES

We will acknowledge every email within three hours and have a proposal ready within 24 hours.

PERSONAL SUPPORT

For every event, you will have a dedicated, highly trained event assistant at your service.

ORGANISER SUITE

An upgraded guestroom is provided at no extra charge for the group organiser, with complimentary facilities inclusive of an espresso machine, in-room printer and fax services available on demand. All rooms are replenished daily with water, soft drinks and fresh fruit.

EFFECTIVE COMMUNICATION

To give you 24-hour access to our events team, we provide a complimentary mobile phone pre-programmed with important telephone numbers.

BESPOKE LANDING PAGES ON CORINTHIA.COM

We will create and customise a page especially for your meeting, allowing your delegates to register direct. We can display maps, agendas, event details and more on your bespoke landing page.

READY WHEN YOU ARE

We leave nothing to chance – studying your schedule carefully to ensure everything is planned and provided for. You will have access to your event rooms at least one hour in advance, or more if need be.



Corinthia Hotels' mobile application created specifically around the needs of meetings organisers and attendees.

VIEW FROM THE ROYAL
PENTHOUSE AT CORINTHIA
HOTEL LONDON



GREAT DESTINATIONS

Corinthia destinations have so much to offer. St Petersburg, Budapest, Prague and Lisbon are vibrant cities that make perfect settings for meetings and conferences. The Mediterranean island of Malta delivers a warm welcome and a fine tradition of hospitality. For the more adventurous, Tripoli and Khartoum boast an abundance of culture and archaeology. London, where our grand hotel is in the heart of the capital, presents astonishing cultural diversity, regal history, iconic architecture and enough creative energy to captivate anyone.

OUTSTANDING LOCAL KNOWLEDGE

At every Corinthia Hotel we pride ourselves on our local knowledge, and our expert team will help you plan your programme to capture the spirit of your destination.

Corinthia Hotel London
Whitehall Place, London
SW1A 2BD, United Kingdom
T: +44 (0) 20 7930 8181
E: events.london@corinthia.com

294 BEDROOMS
0.1 KM TO CITY CENTRE
8 MEETING ROOMS
250 SEATS
THEATRE STYLE IN MAIN MEETING ROOM

CORINTHIA HOTEL LONDON

Illustrious history, iconic galleries and museums, astonishing cultural diversity... it's no wonder London has become the world's number one destination.

There's always so much happening in this great city and we have the ultimate venue for high level meetings and corporate events. Corinthia Hotel London is the jewel in the crown of our hotel portfolio. It's a graceful and historic 21st Century Grand Hotel in a perfect location close to Trafalgar Square, yet it has a thoroughly modern ambience with opulently furnished guestrooms and suites. There's a wide choice of spaces for exclusive private and corporate events, ranging from the magnificent Belle Époque Ballroom to the elegant complex of smaller meeting rooms, where understated elegance meets efficiency. In short, everything that the most demanding international traveller could want is here, including exquisite private dining, world class service and the best spa of any London hotel.



- Perfectly positioned in the heart of London.
- 31 km from Heathrow Airport, 47 km from Gatwick Airport and 8 km from London City Airport.
- 294 rooms, consisting of 47 suites, 7 of which are sensational unique Penthouses. All rooms and suites have a media hub, safe, minibar, tea and coffee making facilities, complimentary WiFi and cable Internet access.
- Elegant and dramatic Ballroom which accommodates up to 400 (reception) or 180 (banquet).
- A choice of six unique meeting rooms, all of which are situated on the mezzanine level.
- Mezzanine meeting rooms have the latest technology, including drop-down projectors and plasma screens. In addition, high definition technology provides total media connectivity across five meeting rooms and five guestrooms.
- The Northall features modern British cuisine while Massimo Restaurant & Oyster Bar showcases Italian culinary excellence. Fine dining is available in the Ballroom as well as restaurants.
- ESPA Life at Corinthia is dramatically located over four floors, a wonderful space for relaxation and rejuvenation. The gym, available 24 hours, is exceptionally well equipped with the latest technology, fitness equipment and sport therapies.



| | Square metres | Ceiling height (metres) | Square feet | Ceiling height (feet) | Theatre (capacity) | Cabaret front projection (capacity) | Classroom (capacity) | Boardroom (capacity) | Banquet (capacity) | Reception (capacity) |
|------------------------|---------------|-------------------------|-------------|-----------------------|--------------------|-------------------------------------|----------------------|----------------------|--------------------|----------------------|
| The Ballroom | 218 | 7.1 | 2346.6 | 23.3 | 250 | 120 | 120 | 56 | 180 | 400 |
| The Courtroom | 121 | 5.8 | 1302.5 | 19 | 150 | 40 | 64 | 48 | 90 | 200 |
| Pre Function Area | 82 | 3.4 | 882.7 | 11.2 | – | – | – | – | – | – |
| 1 The Orion Room | 33 | 3 | 355.2 | 9.8 | 30 | 16 | 12 | 20 | – | – |
| 2 The Codrington | 33 | 3 | 355.2 | 9.8 | 30 | 16 | 12 | 20 | – | – |
| 3 The Hardy Room | 33 | 3 | 355.2 | 9.8 | 30 | 16 | 12 | 20 | – | – |
| 4 The Victory Room | 32 | 3 | 344.5 | 9.8 | – | – | – | 22 | – | – |
| 5 The Collingwood Room | 34 | 3 | 366 | 9.8 | – | – | – | 22 | – | – |
| 6 The Nelson Room | 78 | 3 | 839.6 | 9.8 | 60 | 32 | 36 | 25 | – | 70 |

CORINTHIA HOTEL ST PETERSBURG

Founded by Peter the Great in 1703, St Petersburg was once the home of the tsars and it still evokes the age of Russian imperial elegance and culture.

Today it is a modern and cosmopolitan city that is rich in magnificent architecture, theatres, concert halls, galleries and it has one of the world's great museums – the Hermitage. Corinthia Hotel St Petersburg is itself part of the city's glorious cultural heritage. A landmark on the famous Nevsky Prospect, our hotel is an award-winning renovation of two majestic 19th century buildings. The opulent interior overflows with art, contemporary style and exquisite luxury.



Corinthia Hotel St Petersburg
Nevsky Prospect 57,
St. Petersburg, Russia 191025
T: +7 812 380 2001
E: events.stpetersburg@corinthia.com

388 BEDROOMS
0 KM TO CITY CENTRE
17 MEETING ROOMS
550 SEATS THEATRE STYLE IN MAIN MEETING ROOM

- Great location in the heart of the city close to all the major historical sites and within walking distance from the Hermitage. 17 km from Pulkovo International Airport.
- 388 comfortable and elegant rooms and suites, including 107 Executive Rooms. All rooms have central air conditioning and heating, safe, minibar, WiFi access, desk and LCD satellite TV.
- Executive Wing has 107 rooms and an Executive Lounge.
- Extensive range of conference and banqueting facilities that can accommodate a wide range of events. Corinthia Hotel St Petersburg has the largest capacity of any five-star hotel in the city.
- The Samoilov theatrical museum is located within the hotel complex and can be used as a unique venue. We can also arrange events in magnificent locations such as the imperial palaces.
- Two restaurants & three bars offering Russian and international cuisine.
- Fully equipped fitness centre with sauna, solarium, outdoor sun terrace and massage room.



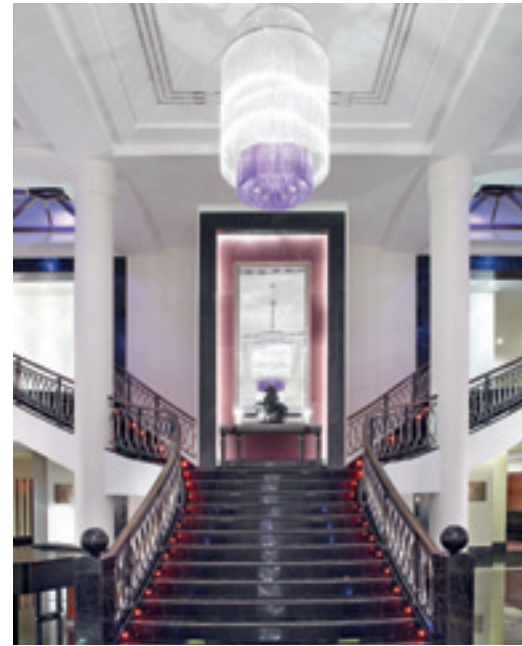
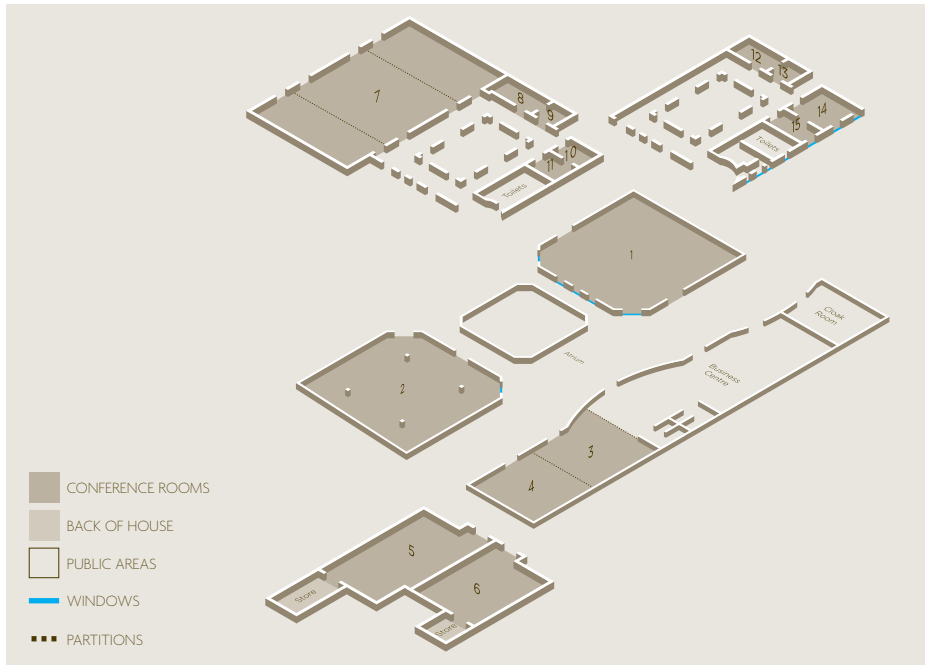

| | | Square metres | Ceiling height (metres) | Square feet | Ceiling height (feet) | Theatre (capacity) | Cabaret front projection (capacity) | Cabaret back projection (capacity) | Classroom (capacity) | Boardroom (capacity) | Banquet (capacity) | Reception (capacity) |
|---|-------------------------|---------------|-------------------------|-------------|-----------------------|--------------------|-------------------------------------|------------------------------------|----------------------|----------------------|--------------------|----------------------|
| 1 | Saint-Petersburg | 195 | 3 | 2099 | 9.8 | 180 | 80 | 60 | 90 | 50 | 100 | 150 |
| 2 | Admiralty | 110 | 3 | 1184 | 9.8 | 96 | 50 | 40 | 45 | 22 | 60 | 120 |
| 3 | Moscow 1 | 43 | 3 | 461 | 9.8 | 40 | 14 | – | 20 | 18 | 30 | 40 |
| 4 | Moscow 2 | 43 | 3 | 461 | 9.8 | 40 | 14 | – | 20 | 18 | 30 | 40 |
| | Moscow 1+2 | 86 | 3 | 922 | 9.8 | 80 | 24 | – | 40 | 30 | 60 | 80 |
| | Nevsky Ballroom | 535 | 6.4 | 5748 | 21 | 550 | 320 | 160 | 273 | 120 | 380 | 500 |
| | Nevsky Ballroom 1 | 151 | 6.4 | 1623 | 21 | 96 | 60 | 40 | 54 | 50 | 70 | 150 |
| | Nevsky Ballroom 2 | 234 | 6.4 | 2519 | 21 | 192 | 100 | 54 | 108 | 70 | 140 | 250 |
| | Nevsky Ballroom 3 | 151 | 6.4 | 1623 | 21 | 96 | 60 | 40 | 54 | 50 | 70 | 150 |
| | Nevsky Ballroom 1+2/2+3 | 385 | 6.4 | 4142 | 21 | 350 | 240 | 80 | 162 | 80 | 180 | 300 |
| | Samara 1 | 29 | 2.8 | 310 | 9.1 | – | – | – | – | 12 | – | – |
| | Samara 2 | 14 | 2.8 | 151 | 9.1 | – | – | – | – | 2 | – | – |
| | Sochi 1 | 19 | 2.8 | 205 | 9.1 | – | – | – | – | 8 | – | – |
| | Sochi 2 | 19 | 2.8 | 205 | 9.1 | – | – | – | – | 8 | – | – |
| | Novgorod 1 | 29 | 2.7 | 310 | 8.8 | – | – | – | – | 12 | – | – |
| | Novgorod 2 | 14 | 2.7 | 151 | 8.8 | – | – | – | – | 2 | – | – |
| | Kazan 1 | 49 | 2.7 | 527 | 8.8 | – | – | – | – | 15 | – | – |
| | Kazan 2 | 23 | 2.7 | 248 | 8.8 | – | – | – | – | 10 | – | – |
| 5 | Boardroom 1 | 30 | 2.2 | 323 | 7.2 | – | – | – | – | 10 | – | – |
| 6 | Boardroom 2 | 22 | 2.2 | 237 | 7.2 | – | – | – | – | 10 | – | – |

Corinthia Hotel Budapest
Erzsébet körút 43-49,
1073 Budapest, Hungary
T: +36 1 479 4000
E: events.budapest@corinthia.com

CORINTHIA HOTEL BUDAPEST

Straddling the Danube, Budapest is widely regarded as one of the world's most beautiful cities.

With its noble architecture, sweeping vistas and lively, cosmopolitan atmosphere, this is a truly inspirational destination and a great venue for corporate meetings and events. Corinthia Hotel Budapest is within walking distance of several of the city's most exciting attractions. The finest hotel in the heart of the city, it captures the city's glamour and romance. Formerly the Grand Hotel Royal, we have transformed it to the highest standards of contemporary luxury, while retaining the beautiful historical features such as marble floors, a grand sweeping staircase and stunning six-storey atrium. The original Royal Spa has been given a new lease of life, remodelled as a luxurious and contemporary spa with a 15 metre pool.



414
BEDROOMS

0.5 KM
TO CITY CENTRE

31
MEETING ROOMS

500 SEATS
THEATRE STYLE IN
MAIN MEETING ROOM

- Located in the heart of Budapest and 18 km from Budapest Airport.
- 414 rooms, including 31 suites and 26 apartments. All rooms and suites have safe, minibar, iron/ironing board, tea and coffee making facilities, free entry to the Royal Spa, complimentary WiFi and cable Internet access.
- Executive Lounge and Business Centre.
- Impressive Grand Ballroom restored to its original beauty and richly decorated in Baroque style.
- Corinthia Hotel Budapest has the best choice of meeting space and the largest conference facilities within Hungary's five star hotels. The complex includes the Valletta Conference Centre, a showpiece of 21st century architecture which can be partitioned to create up to 19 syndicate rooms.
- Extensive selection of restaurants, bistros and bars including Rickshaw (Asian), the Brasserie and Atrium restaurants (International), and Bock Bistro (Hungarian).
- Royal Spa with fitness room, indoor heated pool, jacuzzi, sauna and steam bath.



| | Square metres | Ceiling height (metres) | Square feet | Ceiling height (feet) | Theatre (capacity) | Cabaret front projection (capacity) | Cabaret back projection (capacity) | Classroom (capacity) | Boardroom (capacity) | Banquet (capacity) | Reception (capacity) | U-Shape (capacity) |
|--|---------------|-------------------------|-------------|-----------------------|--------------------|-------------------------------------|------------------------------------|----------------------|----------------------|--------------------|----------------------|--------------------|
| 1 Grand Ballroom | 430 | 10.7 | 4628.63 | 34.24 | 500 | 236 | 150 | 280 | 100 | 320 | 500 | 86 |
| Valletta Conference Centre I / 1 screen | 539.85 | 3.7 | 5811.09 | 11.84 | 220 | 150 | 96 | 140 | 80 | 380 | 500 | 90 |
| 2 Petöfi | 84.36 | 3.7 | 908.07 | 11.84 | 55 | 30 | – | 45 | 30 | 50 | 75 | 30 |
| 3 Mikszáth | 59.2 | 3.7 | 637.24 | 11.84 | 48 | 24 | – | 35 | 20 | 30 | 50 | 24 |
| 4 Déry | 73.26 | 3.7 | 788.59 | 11.84 | 48 | 30 | – | 35 | 24 | 45 | 65 | 30 |
| 5 Arany | 84.36 | 3.7 | 908.07 | 11.84 | 55 | 30 | – | 45 | 30 | 50 | 75 | 30 |
| 6 Krúdy | 59.2 | 3.7 | 637.24 | 11.84 | 48 | 24 | – | 35 | 20 | 30 | 50 | 24 |
| 7 Jókai | 73.26 | 3.7 | 788.59 | 11.84 | 48 | 30 | – | 35 | 24 | 45 | 70 | 30 |
| Valletta Conference Centre II / 1 screen | 329.4 | 3.7 | 3545.75 | 11.84 | 140 | 84 | 56 | 100 | 50 | 200 | 250 | 55 |
| 8 Ady | 28.86 | 3.7 | 310.66 | 11.84 | 25 | 12 | – | 12 | 12 | 16 | 20 | 15 |
| 9 Lehár | 59.2 | 3.7 | 637.24 | 11.84 | 55 | 30 | – | 35 | 18 | 36 | 50 | 21 |
| 10 Erkel | 47.36 | 3.7 | 509.8 | 11.84 | 35 | 16 | – | 24 | 18 | 24 | 30 | 21 |
| 11 Kazinczy | 39.405 | 3.7 | 424.17 | 11.84 | 35 | 16 | – | 20 | 18 | 24 | 30 | 21 |
| 12 József | 59.2 | 3.7 | 637.24 | 11.84 | 55 | 30 | – | 35 | 18 | 36 | 50 | 21 |
| 13 Kólcsey | 28.86 | 3.7 | 310.66 | 11.84 | 25 | 12 | – | 12 | 12 | 16 | 20 | 15 |
| Valletta Exhibition Centre/ 1 screen | 739.65 | 3.45 | 7961.79 | 11.04 | 270 | 154 | 112 | 140 | 90 | 450 | 650 | 80 |
| 14 Tas | 150.8 | 3.45 | 1623.25 | 11.04 | 100 | 48 | – | 60 | 30 | 100 | 135 | 35 |
| 15 Huba | 84.8 | 3.45 | 912.8 | 11.04 | 70 | 40 | – | 45 | 26 | 50 | 75 | 24 |
| 16 Töhötöm | 84.8 | 3.45 | 912.8 | 11.04 | 70 | 40 | – | 45 | 26 | 50 | 75 | 24 |
| 17 Álmos | 52.8 | 3.45 | 568.35 | 11.04 | 40 | 24 | – | 28 | 18 | 30 | 45 | 15 |
| 18 Előd | 52.8 | 3.45 | 568.35 | 11.04 | 40 | 24 | – | 28 | 18 | 30 | 45 | 15 |
| 19 Ond | 52.8 | 3.45 | 568.35 | 11.04 | 40 | 24 | – | 28 | 18 | 30 | 45 | 15 |
| 20 Kond | 68.64 | 2.94 | 738.86 | 11.04 | 45 | 24 | – | 30 | 24 | 40 | 60 | 15 |
| Room 1203 | 20.58 | 2.94 | 221.53 | 9.41 | | | | | 8 | – | – | – |
| Room 1213 | 17.6 | 2.94 | 189.45 | 9.41 | | | | | 8 | – | – | – |
| Room 1223 | 17.6 | 2.94 | 189.45 | 9.41 | | | | | 8 | – | – | – |
| Room 2203 | 19.11 | 2.94 | 205.71 | 9.41 | | | | | 8 | – | – | – |
| Room 2330 | 39.75 | 2.94 | 427.88 | 9.41 | | | | | 15 | – | – | – |
| Room 3203 | 19.11 | 2.94 | 205.71 | 9.41 | | | | | 8 | – | – | – |
| Room 3135 | 39.75 | 2.94 | 427.88 | 9.41 | | | | | 15 | – | – | – |
| Room 3330 | 39.75 | 2.94 | 427.88 | 9.41 | | | | | 15 | – | – | – |
| Room 4203 | 19.11 | 2.94 | 205.71 | 9.41 | | | | | 8 | – | – | – |

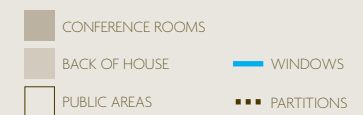
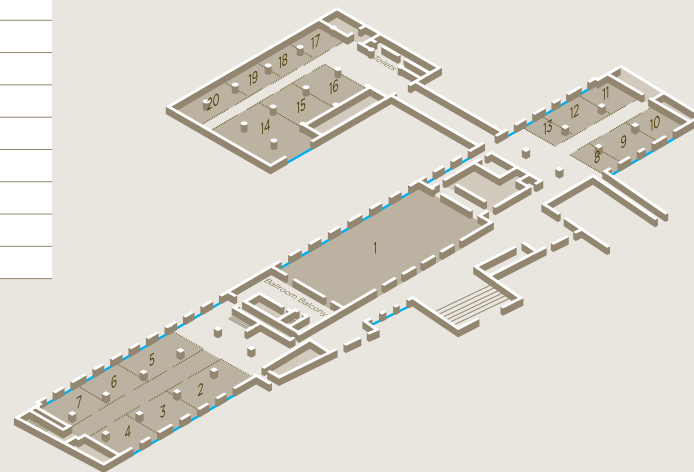

Corinthia Hotel Tripoli
Souk Al Thulatha Al Gadim,
Tripoli 82874, Libya
T: +218 21 335 1990
E: events.tripoli@corinthia.com

299
BEDROOMS

6
MEETING ROOMS

0 KM
TO CITY CENTRE

500 SEATS
THEATRE STYLE IN
MAIN MEETING ROOM

CORINTHIA HOTEL TRIPOLI

Once part of the Roman Empire, Tripoli is today Libya's prosperous capital city and the gateway to the country's well-preserved ancient sites such as Leptis Magna and Sabratha.

The impressive twin towers of Corinthia Hotel Tripoli stand as landmarks on the shoreline of the Mediterranean sea. Strategically located in the hub of the central business district, the hotel offers international five-star quality. The picturesque Medina with its ancient fortifications is nearby, while other attractions such as the artisan market, Assaraia Al-Hamra (Red Castle) and Marcus Aurelius arch are all within walking distance.



- Located on the seafront near Tripoli's main business area and close to several of the city's visitor attractions. 0.5 km from the city centre and 35 km from Tripoli International Airport.
- 299 rooms, with sea views, including 65 Executive Rooms and 34 suites. All rooms and suites have safe, minibar, 42" LCD TV media hub and connectivity panel.
- Executive Lounge and Business Centre.
- Extensive conference and events facilities, including a range of exclusive halls, meeting rooms, boardrooms with magnificent views.
- A wide choice of restaurants, cafés and grills including La Valette (main restaurant), Venezia (Italian) and Fes (Moroccan).
- Athenaeum Spa including leisure and fitness centre, with steam room, jacuzzi, sauna, indoor and outdoor pools.

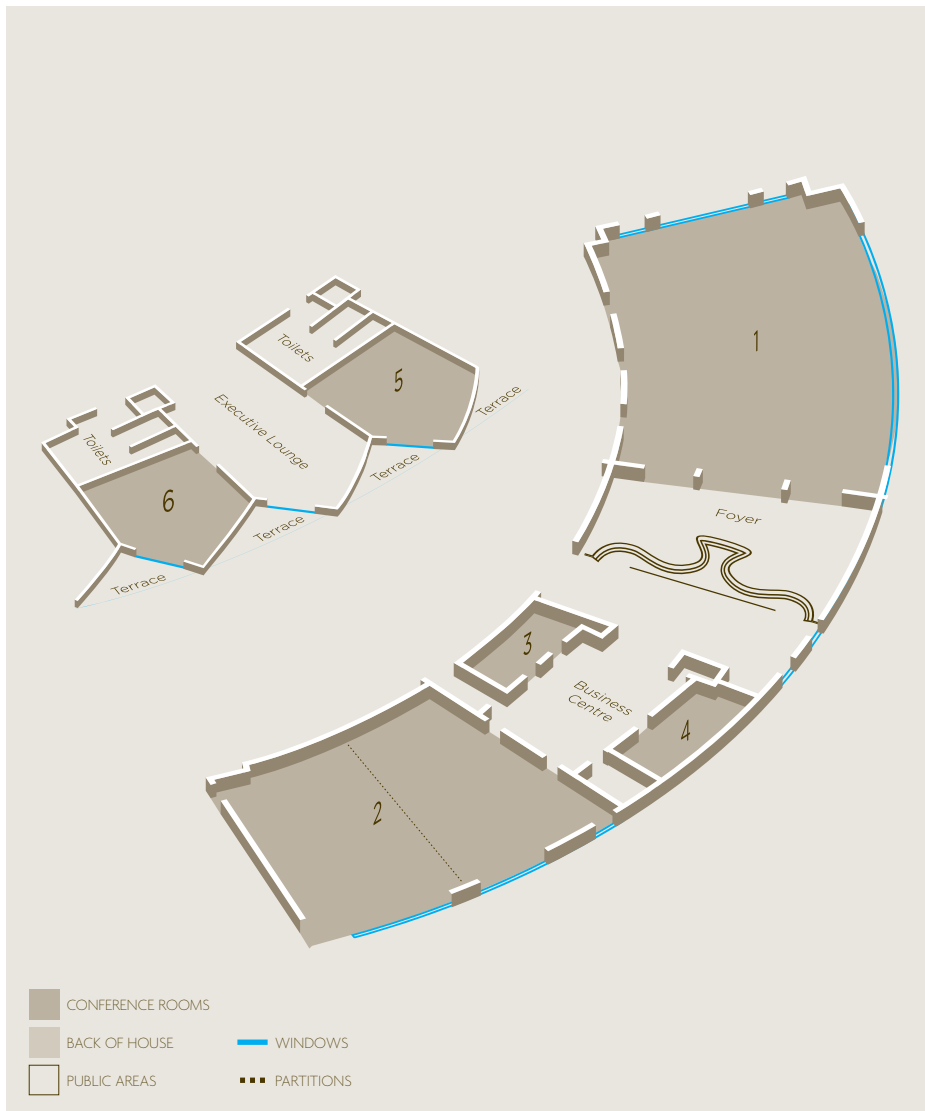

| | | Square metres | Ceiling height (metres) | Square feet | Ceiling height (feet) | Theatre (capacity) | Cabaret front projection (capacity) | Cabaret back projection (capacity) | Classroom (capacity) | Boardroom (capacity) | Banquet (capacity) | Reception (capacity) |
|---|---------------------|---------------|-------------------------|-------------|-----------------------|--------------------|-------------------------------------|------------------------------------|----------------------|----------------------|--------------------|----------------------|
| 1 | Lebdah | 17.4 | 29.6 | 6.15 | 57'1 | 971 | 20'2 | 500 | 360 | – | 300 | 600 |
| 2 | Shahhat | 17.8 | 22 | 3.8 | 58'5 | 72'2 | 12'6 | 300 | 260 | – | 200 | 350 |
| | Shahhat partitioned | 17.8 | 11 | 3.8 | 58'5 | 36'1 | 12'6 | 100 | 80 | – | 70 | 200 |
| 3 | Sabratha | 4.2 | 9.4 | 3.15 | 13'9 | 30'10 | 10'4 | – | – | 16 | – | – |
| 4 | Ghadames | 4.2 | 8.6 | 3.15 | 13'9 | 28'3 | 10'4 | – | – | 16 | – | – |
| 5 | Boardroom I | 5 | 5.5 | 3.15 | 16'5 | 18'1 | 10'4 | – | – | 10 | – | – |
| 6 | Boardroom II | 5 | 5.5 | 3.15 | 16'5 | 18'1 | 10'4 | – | – | 10 | – | – |

Corinthia Hotel Lisbon
Av. Columbano Bordalo,
Pinheiro, 105, 1099-031,
Lisbon, Portugal
T: +351 (21) 723 6363
E: events.lisbon@corinthia.com

518
BEDROOMS

18
MEETING ROOMS

3 KM
TO CITY CENTRE

800 SEATS
THEATRE STYLE IN
MAIN MEETING ROOM

CORINTHIA HOTEL LISBON

Situated on the edge of the Atlantic Ocean, Lisbon is a diverse and friendly city, and an enchanting location for meetings and corporate events.

The area is rich in palaces, monasteries and castles, while the Estoril Coast offers great opportunities to unwind with its superb beaches, water sports and golf facilities. Elegant and stylish accommodation, combined with convenience, make the Corinthia Hotel Lisbon the city's most distinctive hotel. The hotel has views to the 18th century aqueduct and the beautiful Monsanto Nature Park, and is only a short distance away from the city centre with its museums, boulevards and shops.



- Located 3 km from Lisbon's cultural centre and 7 km from Lisbon Airport.
- 518 guestrooms and suites, 76 of which are Executive Club rooms on the top floors.
- All rooms and suites have safe, minibar, tea and coffee making facilities, desk, direct dial telephone and complimentary WiFi Internet.
- Club Lounge on the 24th floor has spectacular city views.
- Corinthia Hotel Lisbon is one of the city's top conference hotels and has the largest capacity. Its modern, purpose-built Congress Centre provides flexible opportunities for staging inspirational meetings, exhibitions and events.
- Restaurants include Tipico (main restaurant with live-cooking and fine dining), and Sete Colinas (buffet breakfast, banqueting and special events).
- The spa has a state-of-the-art gym, heated indoor swimming pool with retractable roof, and an acqua thermal Spa offering hot and cold bathing rituals.

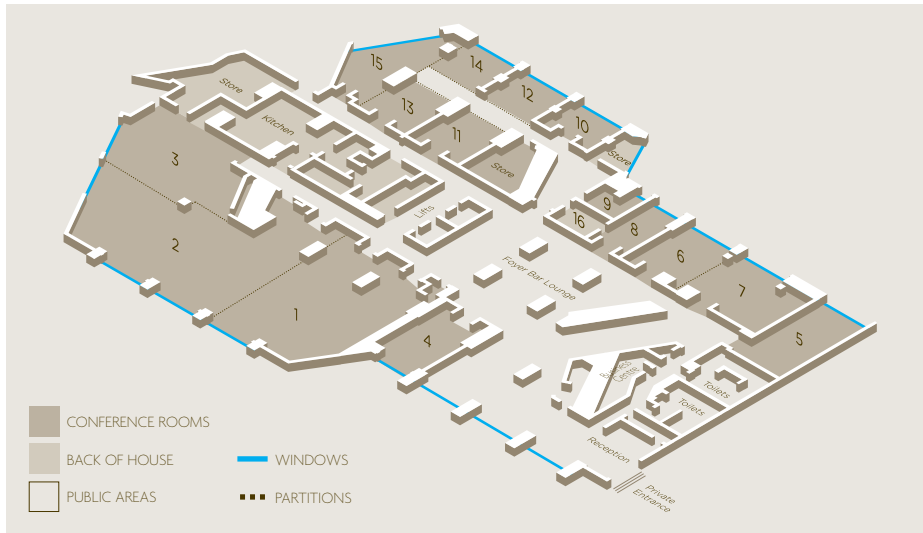

| | Square metres | Ceiling height (metres) | Square feet | Ceiling height (feet) | Theatre (capacity) | Cabaret front projection (capacity) | Cabaret back projection (capacity) | Classroom (capacity) | Boardroom (capacity) | Banquet (capacity) | Reception (capacity) |
|-------------------|---------------|-------------------------|-------------|-----------------------|--------------------|-------------------------------------|------------------------------------|----------------------|----------------------|--------------------|----------------------|
| 1. Floriana I | 265 | 3.60 | 2852 | 11'10 | 230 | 80 | 70 | 130 | 70 | 150 | 310 |
| 2. Floriana II | 340 | 3.60 | 3660 | 11'10 | 400 | 160 | 140 | 200 | 90 | 250 | 400 |
| 3. Floriana III | 170 | 3.60 | 1830 | 11'10 | 150 | 70 | 60 | 80 | 45 | 80 | 100 |
| Floriana I+II | 600 | 3.60 | 6458 | 11'10 | 650 | 350 | 320 | 370 | 150 | 400 | 550 |
| Floriana II+III | 510 | 3.60 | 5489 | 11'10 | 570 | 350 | — | 275 | 40 | 380 | 600 |
| Floriana I+II+III | 775 | 3.60 | 8342 | 11'10 | 800 | 450 | — | 400 | 150 | 550 | 1000 |
| 4. Ametista | 70 | 3.40 | 753 | 11'2 | 60 | 35 | — | 40 | 20 | 40 | 50 |
| 5. Aguamarinha | 100 | 3.40 | 1076 | 11'2 | 80 | 50 | — | 50 | 28 | 50 | 80 |
| 6. Jade I | 65 | 3.40 | 700 | 11'2 | 50 | 30 | — | 25 | 24 | 40 | 40 |
| 7. Jade II | 100 | 3.40 | 1076 | 11'2 | 80 | 45 | — | 50 | 30 | 60 | 100 |
| Jade I+II | 165 | 3.40 | 1776 | 11'2 | 140 | 80 | 70 | 80 | 40 | 100 | 200 |
| 8. Ruby | 45 | 3.40 | 484 | 11'2 | 30 | * | — | 20 | 15 | 14 | 20 |
| 9. Turquesa | 25 | 3.40 | 269 | 11'2 | 10 | * | — | 10 | 10 | 10 | 15 |
| 10. Safira | 40 | 3.40 | 430 | 11'2 | 30 | 10 | — | 20 | 16 | 14 | 30 |
| 11. Esmeralda I | 50 | 3.40 | 538 | 11'2 | 30 | 36 | — | 24 | 16 | 30 | 60 |
| 12. Esmeralda II | 45 | 3.40 | 484 | 11'2 | 30 | 25 | — | 20 | 16 | 20 | 20 |
| Esmeralda I+II | 115 | 3.40 | 1238 | 11'2 | 115 | 70 | — | 50 | 70 | 60 | 140 |
| 13. Opala I | 50 | 3.40 | 538 | 11'2 | 35 | 36 | 60 | 20 | 16 | 14 | 60 |
| 14. Opala II | 45 | 3.40 | 484 | 11'2 | 30 | 25 | — | 20 | 16 | 14 | 50 |
| 15. Opala III | 80 | 3.40 | 861 | 11'2 | 70 | 25 | — | — | 16 | 20 | 90 |
| Opala I+II | 115 | 3.40 | 1238 | 11'2 | 100 | 70 | 60 | 50 | 70 | 50 | 140 |
| Opala I+II+III | 200 | 3.40 | 2153 | 11'2 | 150 | * | — | 60 | 70 | 80 | 230 |
| 16. Topazio | 20 | 2.60 | 215 | 8'5 | 10 | 6 | — | 9 | 8 | 8 | 10 |
| Afonso Henriques | 50 | 3.10 | 538 | 10'2 | — | — | — | — | 16 | — | — |
| Marquês de Niza | 40 | 3.10 | 430 | 10'2 | — | — | — | — | 10 | — | — |

Corinthia Hotel Prague
Kongresová 1, 140 69 Prague 4,
Czech Republic
T: +420 261 191 111
E: events.prague@corinthia.com

539
BEDROOMS

22
MEETING ROOMS

1.5 KM
TO CITY CENTRE

500 SEATS
THEATRE STYLE IN
MAIN MEETING ROOM

CORINTHIA HOTEL PRAGUE

Prague is one of Europe's most resplendent capital cities, rich in architecture and culture.

Its imposing palace, vast Wenceslas Square, picture-book clock tower and elegant Charles Bridge are unique landmarks. The city's oldest castle, the 10th century Vysehrad, is within a ten-minute walk of our hotel. The city hosts a year-round calendar of music and cultural events, and offers an innovative range of imaginative incentive group challenges. Corinthia Hotel Prague stands at the crown of one of Prague's seven hills and offers breathtaking panoramic views across the city. There is extensive executive accommodation with adjacent business lounges and spacious meeting facilities, making this a great backdrop for corporate events.

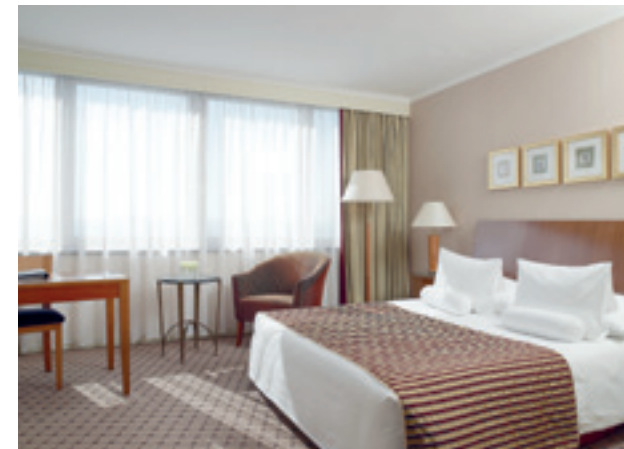

- A landmark building overlooking the city adjacent to Prague Congress Centre only 5 minutes from the historic city centre (the hotel has its own metro station). 20 km from Vaclav Havel Airport Prague.
- 539 air conditioned rooms, including 66 Executive Rooms and 22 suites. All rooms and suites have safe, minibar, WiFi and cable Internet access.
- The Corinthia Conference and Events Centre offers extensive conference facilities for up to 1000 delegates. Occupying an entire hotel floor, the meeting facilities are divided in two separate sections joined by a scenic foyer with panoramic views over the city. In addition, the exclusive Bellevue Conference Hall crowns the hotel 24 floors above the ground level with breathtaking views of the city's skyline.
- Impeccable hotel service is complemented by superb amenities including a beauty parlour, hairdressing salon, gift shop, café, bar, an array of restaurants such as award-winning Rickshaw Restaurant, The Grill Restaurant, Café Praha and premier jazz bar Blue Note.
- Top floor Apollo Day Spa with modern-equipped gym, indoor swimming-pool with panoramic city views, sauna, steam room, solarium, massage and beauty parlour.

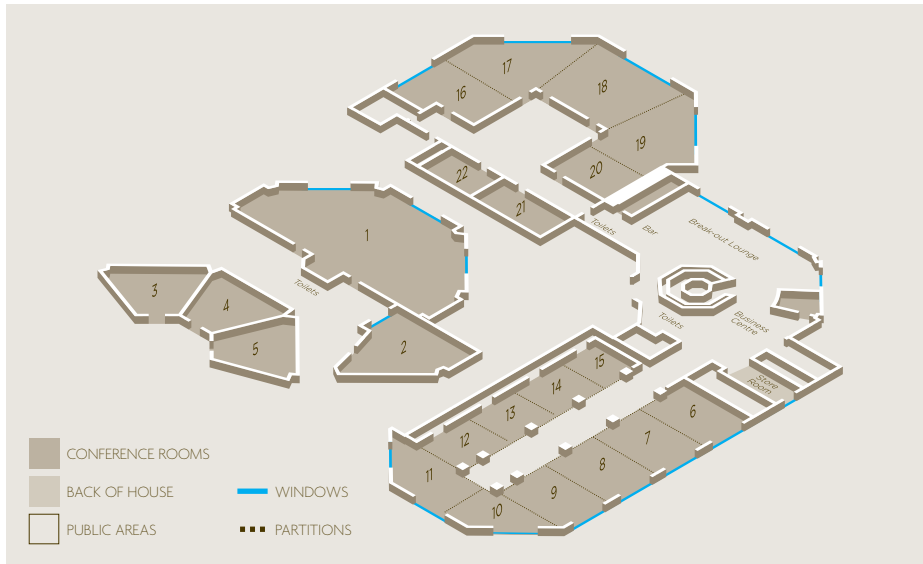

| | Square metres | Ceiling height (metres) | Square feet | Ceiling height (feet) | Theatre (capacity) | Cabaret front projection (capacity) | Cabaret back projection (capacity) | Classroom (capacity) | Boardroom (capacity) | Banquet (capacity) | Reception (capacity) |
|-------------------|---------------|-------------------------|-------------|-----------------------|--------------------|-------------------------------------|------------------------------------|----------------------|----------------------|--------------------|----------------------|
| 1 Bellevue Hall | 266 | 3.9 | 2863.3 | 12.8 | 300 | 120 | 80 | 180 | 42 | 170 | 250 |
| 2 Cocktail Lounge | 80 | 2.5 | 861.1 | 8.2 | 50 | 32 | – | 24 | 18 | 40 | 70 |
| 3 Salon A | 53 | 2.6 | 570.5 | 8.5 | 30 | 16 | – | 14 | 12 | 20 | 30 |
| 4 Salon B | 53 | 2.6 | 570.5 | 8.5 | 30 | 16 | – | 14 | 12 | 20 | 30 |
| 5 Salon C | 53 | 2.6 | 570.5 | 8.5 | 30 | 16 | – | 14 | 12 | 20 | 30 |
| Suite 1 | 732 | 3.15 | 7879 | 10.3 | 500 | 320 | 240 | 350 | – | 430 | 700 |
| 6 Tiber | 70 | 3.15 | 753.5 | 10.3 | 60 | 16 | – | 27 | 12 | 30 | 40 |
| 7 Seine | 70 | 3.15 | 753.5 | 10.3 | 60 | 16 | – | 27 | 12 | 30 | 40 |
| 8 Rhine | 70 | 3.15 | 753.5 | 10.3 | 60 | 16 | – | 27 | 12 | 30 | 40 |
| 9 Rhone | 68 | 3.15 | 731 | 10.3 | 60 | 16 | – | 27 | 12 | 30 | 40 |
| 10 Vistula | 57 | 3.15 | 613.6 | 10.3 | 40 | 16 | – | 18 | 12 | 20 | 40 |
| 11 Vltava | 80 | 3.15 | 861.1 | 10.3 | 60 | 24 | – | 39 | 18 | 40 | 60 |
| 12 Thames | 44 | 3.15 | 473.6 | 10.3 | 40 | 16 | – | 18 | 12 | 30 | 40 |
| 13 Severn | 44 | 3.15 | 473.6 | 10.3 | 40 | 16 | – | 18 | 12 | 30 | 40 |
| 14 Clyde | 44 | 3.15 | 473.6 | 10.3 | 40 | 16 | – | 18 | 12 | 30 | 40 |
| 15 Shannon | 36 | 3.15 | 387.5 | 10.3 | 30 | 12 | – | 12 | 12 | 20 | 20 |
| Suite 2 | 442 | 3.15 | 4757 | 10.3 | 300 | 150 | 112 | 200 | – | 220 | 330 |
| 16 Volga | 47 | 3.15 | 505 | 10.3 | 25 | 16 | – | 15 | 12 | 30 | 30 |
| 17 Amstel | 62 | 3.15 | 667.4 | 10.3 | 35 | 16 | – | 21 | 12 | 30 | 40 |
| 18 Danube | 79 | 3.15 | 850.4 | 10.3 | 50 | 24 | – | 30 | 18 | 30 | 40 |
| 19 Douro | 55 | 3.15 | 592 | 10.3 | 30 | 16 | – | 21 | 12 | 30 | 40 |
| 20 Oder | 30 | 3.15 | 322.9 | 10.3 | 20 | 12 | – | 12 | 12 | 20 | 20 |
| 21 Loire | 25 | 3.15 | 269.1 | 10.3 | 15 | 8 | – | 9 | 12 | 16 | 15 |
| 22 Elbe | 26 | 3.15 | 279.9 | 10.3 | 15 | 8 | – | 9 | 12 | 16 | 15 |

Corinthia Hotel St. George's Bay
St. George's Bay,
St. Julians STJ 3301, Malta
T: +356 2137 4114
E: events.stgeorges@corinthia.com

249
BEDROOMS

14
MEETING ROOMS

1 KM
TO CITY CENTRE

550 SEATS
THEATRE STYLE IN
MAIN MEETING ROOM

CORINTHIA HOTEL ST GEORGE'S BAY

Our stylish and contemporary St George's Bay hotel is situated at the tip of a peninsula in a tranquil area, at the edge of the Mediterranean. Malta's vibrant nightlife is not too far away.

Its open-air terraces, pool decks and sea views from every window allow guests to make the most of its Mediterranean location. The resort is just a short journey from Valletta and a five minute walk from the sandy beach of St George's Bay. There's an extensive selection of water sports available at the resort, ranging from jet skiing to scuba diving and wind surfing. Our resort includes five pools as well as a children's pool, all overlooking the beautiful St George's Bay.

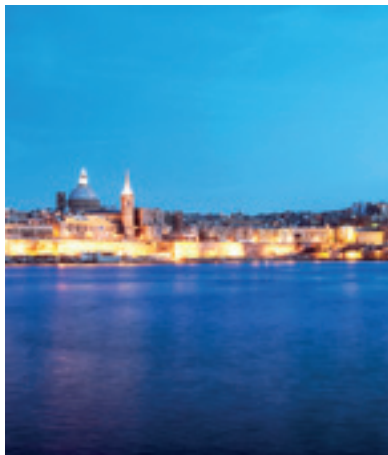

- Unique seafront resort, 10 minutes walk to nightlife and shopping mall. 15 km from Malta International Airport.
- On arrival guests can travel from the airport to the capital Valletta where they have the option to board a large sailing yacht. This will ferry them across the Grand Harbour and a short distance up the coast before checking in at the hotel's private jetty (by prior arrangement).
- 141 standard rooms, 70 executive club and 38 suites, all with balcony. All rooms and suites have safe, minibar, tea and coffee making facilities, Internet access and cable TV.
- There are extensive conference and incentive facilities. The 14 meeting rooms range from boardrooms for 8 delegates to conference rooms for 550 delegates. Most meeting rooms have direct access to sun terraces with garden or sea views.
- Excellent selection of restaurants, including Fra Martino (international buffet), Grill 3301 (fine dining) and Henry J Bean's American Bar & Grill.
- Apollo Day Spa offers health and beauty treatments, indoor pool, jacuzzi, sauna and gym.

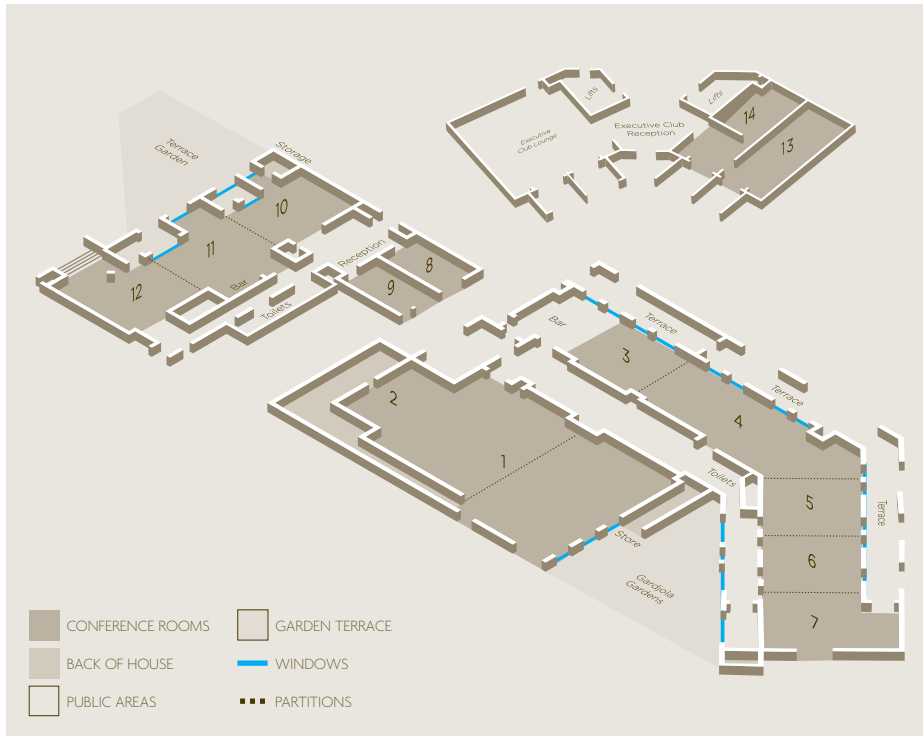

| | | Square metres | Ceiling height (metres) | Square feet | Ceiling height (feet) | Theatre (capacity) | Cabaret front projection (capacity) | Cabaret back projection (capacity) | Classroom (capacity) | Boardroom (capacity) | Banquet (capacity) | Reception (capacity) |
|-----|------------------------------|---------------|-------------------------|-------------|-----------------------|--------------------|-------------------------------------|------------------------------------|----------------------|----------------------|--------------------|----------------------|
| 1 | Fortress Suite | 322 | 4 | 1056'43 | 13'1 | 550 | 220 | 240 | 255 | 80 | 400 | 800 |
| 2 | Stage | 36 | 4 | 118'11 | 11'6 | N/A | N/A | N/A | N/A | N/A | N/A | N/A |
| 3 | Bastion 1 | 96 | 3.18 | 314'96 | 10'5 | 30 | 32 | 32 | 25 | 20 | 40 | 75 |
| 4 | Bastion 2 | 127 | 3.18 | 416'67 | 10'5 | 110 | 70 | 80 | 60 | 60 | 120 | 170 |
| | Bastion 1 & 2 | 223 | 3.18 | 731'63 | 10'5 | 155 | 100 | 110 | 80 | 78 | 170 | 350 |
| 5 | Gardjola 1 | 68 | 3.18 | 223'10 | 10'5 | 40 | 24 | 16 | 27 | 20 | 40 | 65 |
| 6 | Gardjola 2 | 68 | 3.18 | 223'10 | 10'5 | 40 | 24 | 16 | 27 | 20 | 40 | 65 |
| 7 | Gardjola 3 | 85 | 3.18 | 278'87 | 10'5 | 60 | 40 | 32 | 27 | 20 | 50 | 85 |
| | Gardjola 1, 2 & 3 | 221 | 3.18 | 725'07 | 10'5 | 150 | 120 | 100 | 80 | 70 | 160 | 300 |
| 8/9 | Summit & Congress Boardrooms | 23 | 2.75 | 75'46 | 9'0 | – | – | – | – | 12 | – | – |
| 10 | Terrace 1 | 39 | 2.75 | 127'95 | 9'0 | 30 | 30 | 8 | 18 | 16 | – | 30 |
| 11 | Terrace 2 | 51 | 2.75 | 167'32 | 9'0 | 41 | 32 | 24 | 18 | 22 | – | 40 |
| | Terrace 1 & 2 | 91 | 2.75 | 298'56 | 9'0 | 70 | 48 | 48 | 36 | 40 | – | 80 |
| 12 | Terrace 3 | 48 | 2.75 | 157'48 | 9'0 | 30 | – | – | 18 | 16 | – | 30 |
| 13 | Executive 1 | 17 | 2.75 | 55'77 | 9'0 | – | – | – | – | 14 | – | – |
| 14 | Executive 2 | 10 | 2.75 | 32'81 | 9'0 | – | – | – | – | 8 | – | – |

Corinthia Palace Hotel & Spa
De Paule Avenue,
San Anton BZN 9023, Malta
T: +356 2144 0301
E: events.palace@corinthia.com

152
BEDROOMS

6
MEETING ROOMS

8 KM
TO CITY CENTRE

500 SEATS
THEATRE STYLE IN
MAIN MEETING ROOM

CORINTHIA PALACE HOTEL & SPA

The hospitable Maltese Islands have been a meeting place for people and cultures for thousands of years.

Just a two – or three – hour flight from major European capitals, our hotel offers flexible meeting resources and is well placed for exploring the islands' long history and enjoying the world class resort facilities. Created from an elegant Art Nouveau villa, the Corinthia Palace Hotel & Spa is surrounded by lush, landscaped gardens and is adjacent to the President's Palace and the adjoining botanical gardens. The hotel has a superb spa and is centrally located – it is close to the capital city, Valletta, the Royal Malta Golf Club and the ancient walled city of Mdina.



- Located in the heart of the island in a serene and select neighbourhood, 12 minutes drive from Valletta and 5 minutes from Mdina. 7 km from Malta International Airport.
- 152 rooms, all with balcony, including 11 Executive Suites. All rooms and suites have safe, minibar, tea and coffee making facilities, trouser press, direct dial telephone and flat-screen pay TV, free WiFi.
- Conference Rooms with flexible set ups that include Theatre, Board Room, Cabaret, U-shape and more. Various capacities are available in accordance to set ups.
- Choice of eateries including the Rickshaw (Asian) and several Mediterranean inspired restaurants such as Villa Corinthia, Pizza Pasta e Basta (seasonal) and Azure (seasonal).
- Athenaeum Spa is one of Malta's leading five-star spas with indoor pool, kinesis area, fitness room, sauna, whirlpool and solarium among its many features.

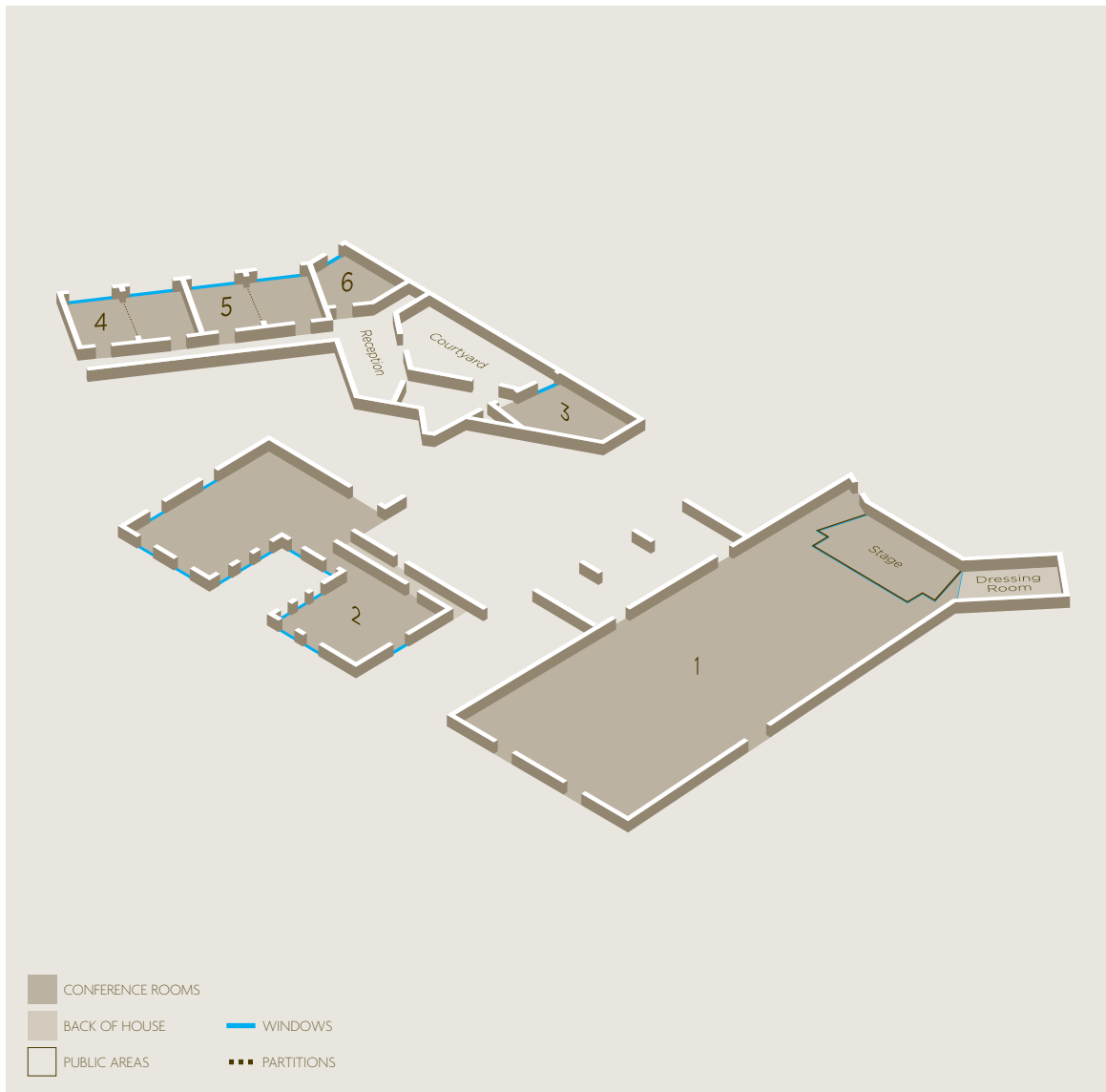

| | | Square metres | Ceiling height (metres) | Square feet | Ceiling height (feet) | Theatre (capacity) | Cabaret front projection (capacity) | Cabaret back projection (capacity) | Classroom (capacity) | Boardroom (capacity) | Banquet (capacity) | Reception (capacity) |
|---|-----------------|---------------|-------------------------|-------------|-----------------------|--------------------|-------------------------------------|------------------------------------|----------------------|----------------------|--------------------|----------------------|
| 1 | Chameleon Suite | 364 | 4 | 3918'2 | 13'1 | 500 | 160 | 120 | 200 | 90 | 300 | 650 |
| 2 | Antoinette Room | 89 | 3.2 | 958'3 | 10'6 | 60 | 32 | – | 40 | 25 | 50 | 80 |
| 3 | President Room | 45 | 3 | 486'7 | 9'10 | 30 | 24 | – | 20 | 22 | – | – |
| 4 | Syndicate Room | 38 | 3 | 408'2 | 9'10 | – | – | – | – | 20 | – | – |
| 5 | The Boardroom | 38 | 3 | 114'8 | 9'10 | – | – | – | – | 20 | – | – |
| 6 | Ambassador Room | 31 | 3 | 328'3 | 9'10 | – | – | – | – | 12 | – | – |

Corinthia Hotel Khartoum
Nile Road, P.O. Box 11042,
Khartoum, Sudan
T: +249 (0) 187 155 555
E: events.khartoum@corinthia.com

230
BEDROOMS

7
MEETING ROOMS

1 KM
TO CITY CENTRE

1000 SEATS
THEATRE STYLE IN
MAIN MEETING ROOM

CORINTHIA HOTEL KHARTOUM

At the confluence of the Blue and White Niles, a location resonant with antiquity, lies Khartoum, the thriving capital of Sudan, the second largest country in Africa.

The city is a feast for the senses, a melting pot of sights and sounds; a place of magnificent sunsets, museums, mosques, lush Nile islands and a lively market or souk. Corinthia Hotel Khartoum is a sleekly modern architectural masterpiece with a discreet and sophisticated style of décor. It is set among lush green landscaped gardens and fountains and is conveniently located in the centre of Khartoum's thriving commercial district.

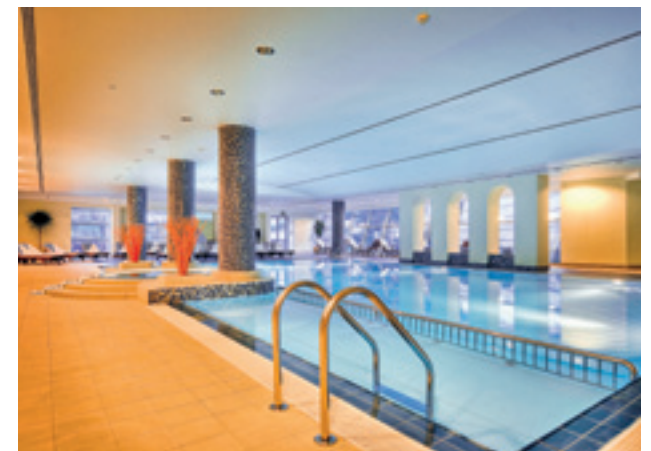

- Situated a short drive from the national museum and 6 km from Khartoum International Airport.
- 230 rooms, including 57 suites. All rooms and suites have safe, minibar and WiFi access.
- Executive Club with special privileges such as private check-in/out, private breakfast, concierge service and Business Centre.
- Extensive and flexible options for events, including full conference and banqueting facilities. Corinthia Hotel Khartoum has the largest meetings capacity of any five-star hotel in the city.
- Large indoor pool, tennis and squash courts, spa with kinesis area, fitness room, sauna, steam bath and Jacuzzi.
- Restaurant choices include the Rickshaw (Asian), Mugran (international), Le Grill (Steak House), Nile River Café, and Africa Garden.

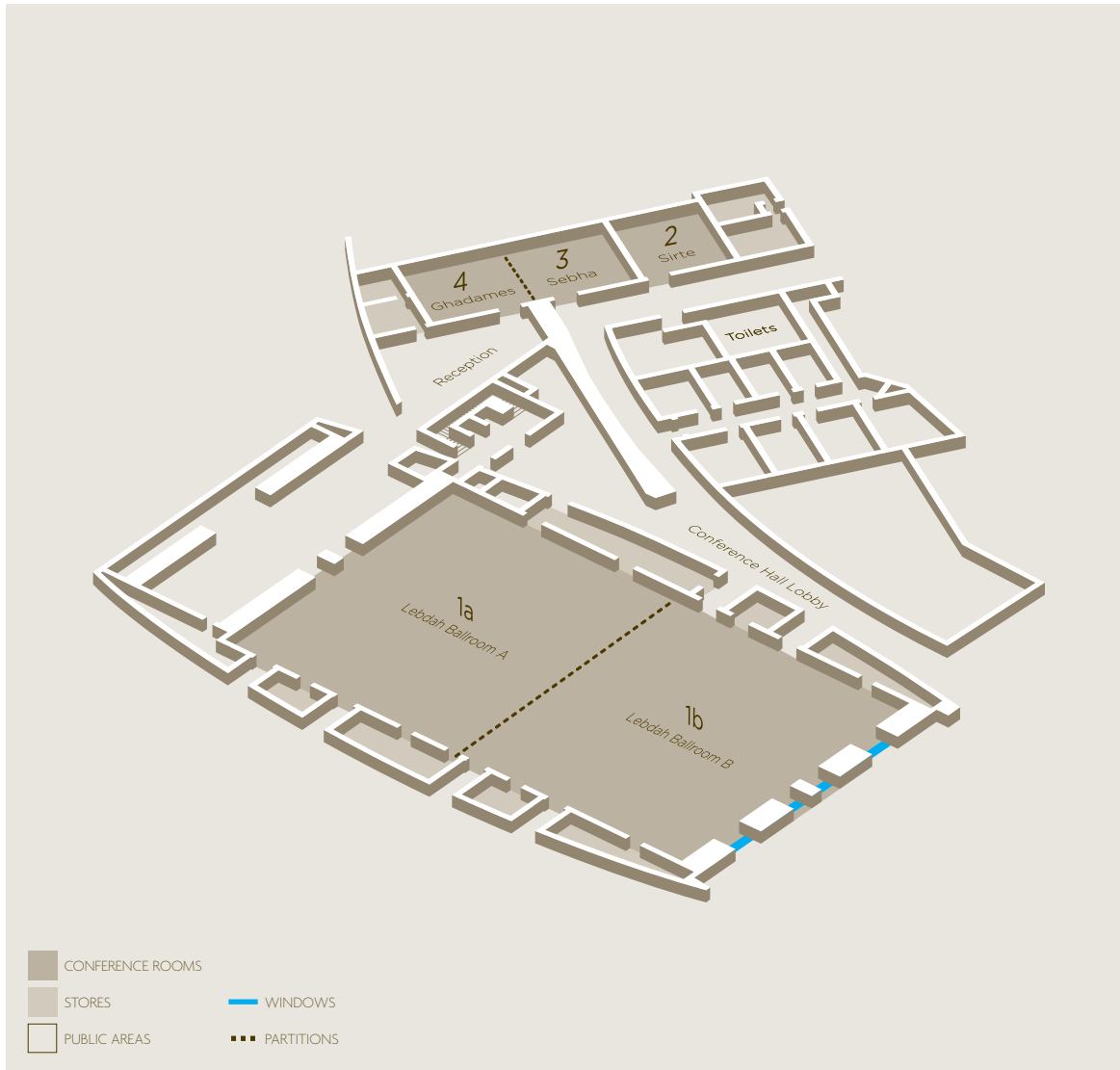

| | Square metres | Ceiling height (metres) | Square feet | Ceiling height (feet) | Theatre (capacity) | Cabaret front projection (capacity) | Cabaret back projection (capacity) | Classroom (capacity) | Boardroom (capacity) | Banquet (capacity) | Reception (capacity) |
|--------------------|---------------|-------------------------|-------------|-----------------------|--------------------|-------------------------------------|------------------------------------|----------------------|----------------------|--------------------|----------------------|
| 1 Lebdah Ballroom | 905.13 | 5.6 | 9655.54 | 18.37 | 1000 | 512 | 512 | 700 | – | 700 | 1200 |
| 1a. Lebdah A | 452.56 | 5.6 | 4827.77 | 18.37 | 500 | 160 | 160 | 300 | – | 300 | 450 |
| 1b. Lebdah B | 452.56 | 5.6 | 4827.77 | 18.37 | 500 | 160 | 160 | 300 | – | 300 | 450 |
| 2 Sirte VIP Lounge | 44 | 2.9 | 473.62 | 9.51 | – | – | – | – | – | 30 | 30 |
| 3 Sebha | 49.5 | 2.9 | 532.83 | 9.51 | 30 | 12 | 12 | 24 | 12 | 30 | 30 |
| 4 Ghadames | 49.5 | 2.9 | 532.83 | 9.51 | 30 | 12 | 12 | 24 | 12 | 30 | 30 |
| Ghadames + Sebha | 99 | 2.9 | 1065.66 | 9.51 | 60 | 36 | 36 | 40 | 20 | 60 | 60 |

FAST FACTS



CORINTHIA HOTEL
LONDON

294
BEDROOMS

8
MEETING ROOMS

0.1 KM
TO CITY CENTRE

250 SEATS
THEATRE STYLE IN MAIN
MEETING ROOM

T +44 (0) 20 7930 8181
EVENTS.LONDON@CORINTHIA.COM

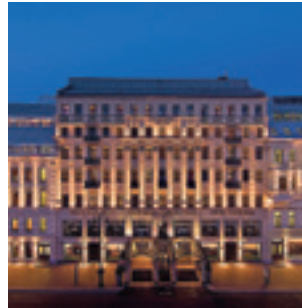

CORINTHIA HOTEL
ST PETERSBURG

388
BEDROOMS

17
MEETING ROOMS

0 KM
TO CITY CENTRE

550 SEATS
THEATRE STYLE IN MAIN
MEETING ROOM

T +7 812 380 2001
EVENTS.STPETERSBURG@CORINTHIA.COM

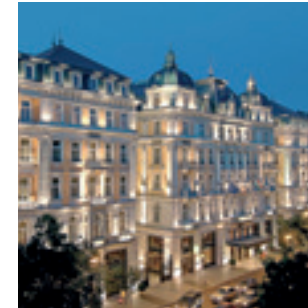

CORINTHIA HOTEL
BUDAPEST

414
BEDROOMS

31
MEETING ROOMS

0.5 KM
TO CITY CENTRE

500 SEATS
THEATRE STYLE IN MAIN
MEETING ROOM

T +36 1 479 4000
EVENTS.BUDAPEST@CORINTHIA.COM



CORINTHIA HOTEL TRIPOLI

299
BEDROOMS

6
MEETING ROOMS

0 KM
TO CITY CENTRE

500 SEATS
THEATRE STYLE IN MAIN
MEETING ROOM

T +218 21 335 1990
EVENTS.TRIPOLI@CORINTHIA.COM



CORINTHIA HOTEL LISBON

518
BEDROOMS

18
MEETING ROOMS

3 KM
TO CITY CENTRE

800 SEATS
THEATRE STYLE IN MAIN
MEETING ROOM

T +351 (21) 723 6363
EVENTS.LISBON@CORINTHIA.COM

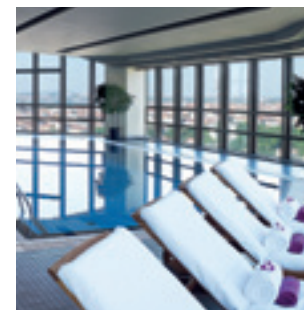

CORINTHIA HOTEL PRAGUE

539
BEDROOMS

22
MEETING ROOMS

1.5 KM
TO CITY CENTRE

500 SEATS
THEATRE STYLE IN MAIN
MEETING ROOM

T +420 261 191 111
EVENTS.PRAGUE@CORINTHIA.COM



CORINTHIA HOTEL
ST GEORGE'S BAY

249
BEDROOMS

14
MEETING ROOMS

1 KM
TO CITY CENTRE

550 SEATS
THEATRE STYLE IN MAIN
MEETING ROOM

T +356 2137 4114
EVENTS.STGEORGES@CORINTHIA.COM



CORINTHIA PALACE
HOTEL & SPA

152
BEDROOMS

6
MEETING ROOMS

8 KM
TO CITY CENTRE

500 SEATS
THEATRE STYLE IN MAIN
MEETING ROOM

T +356 2144 0301
EVENTS.PALACE@CORINTHIA.COM



CORINTHIA HOTEL
KHARTOUM

230
BEDROOMS

7
MEETING ROOMS

1 KM
TO CITY CENTRE

1000 SEATS
THEATRE STYLE IN MAIN
MEETING ROOM

T +249 (0) 187 155 555
EVENTS.KHARTOUM@CORINTHIA.COM

CONTACT US

To find out more about Events at Corinthia or to obtain a proposal, visit our website corinthia.com/events

There's an easy-to-use Request for Proposal tool on our website which allows you to make a detailed request for any type of event. If you prefer to contact one of our regional sales offices, you'll find full details on our website.



EVENTS^{AT} CORINTHIA

LONDON ST PETERSBURG BUDAPEST TRIPOLI LISBON PRAGUE MALTA KHARTOUM